



WOODLANDS

HOTEL & SUITES

A Colonial Williamsburg HOTEL



THE NATURAL CHOICE FOR GROUPS



CONTINENTAL BREAKFAST BAR

Choose it for the value . . . enjoy it for the amenities. This contemporary, 300-room hotel offers moderately priced, comfortable accommodations for every size group.

Take a relaxing stroll across the Visitor Center footbridge or hop on a convenient complimentary shuttle bus to tour Colonial Williamsburg's Historic Area. In the world's largest living history museum, your group will experience colonial life in the re-created public houses, businesses, taverns, homes and streets with insights from lively costumed interpreters.

FEATURES

- Surrounded by a 40-acre pine grove
- A contemporary hotel with a mottled redbrick exterior and expansive use of glass opened in August 2001
- 204 comfortable guest rooms featuring two double beds, flexible seating area with table and chairs, easy chair and pull-out bed
- Additional 96 guest suites with king bed, queen sofa sleeper, upholstered chairs, desk, television, countertop coffeemaker, small refrigerator, microwave and countertop sink
- Guest rooms open to secure interior halls
- Choice of woodland, courtyard, pool or Visitor Center terrace views
- Plentiful parking with bus access to all Colonial Williamsburg sites and attractions
- Corporate and group rates available
- 12,812 square feet of function space at Woodlands Conference Center overlooking stream and waterfall; large outdoor terrace; event space for up to 300 people
- Guests entitled to specially priced Colonial Williamsburg admission tickets
- One of five Colonial Williamsburg lodging properties whose income supports the preservation mission and educational outreach of The Colonial Williamsburg Foundation, a not-for-profit educational institution
- High-speed internet access in all guest rooms and meeting spaces



GUEST ROOM

SUITE

For group reservations or information, contact Colonial Williamsburg Conference Sales at (757) 220-7600 or 1-800-822-9127 or review our website at www.ColonialWilliamsburg.com

WOODLANDS HOTEL & SUITES



MAPLE ROOM



CASCADES ROOM

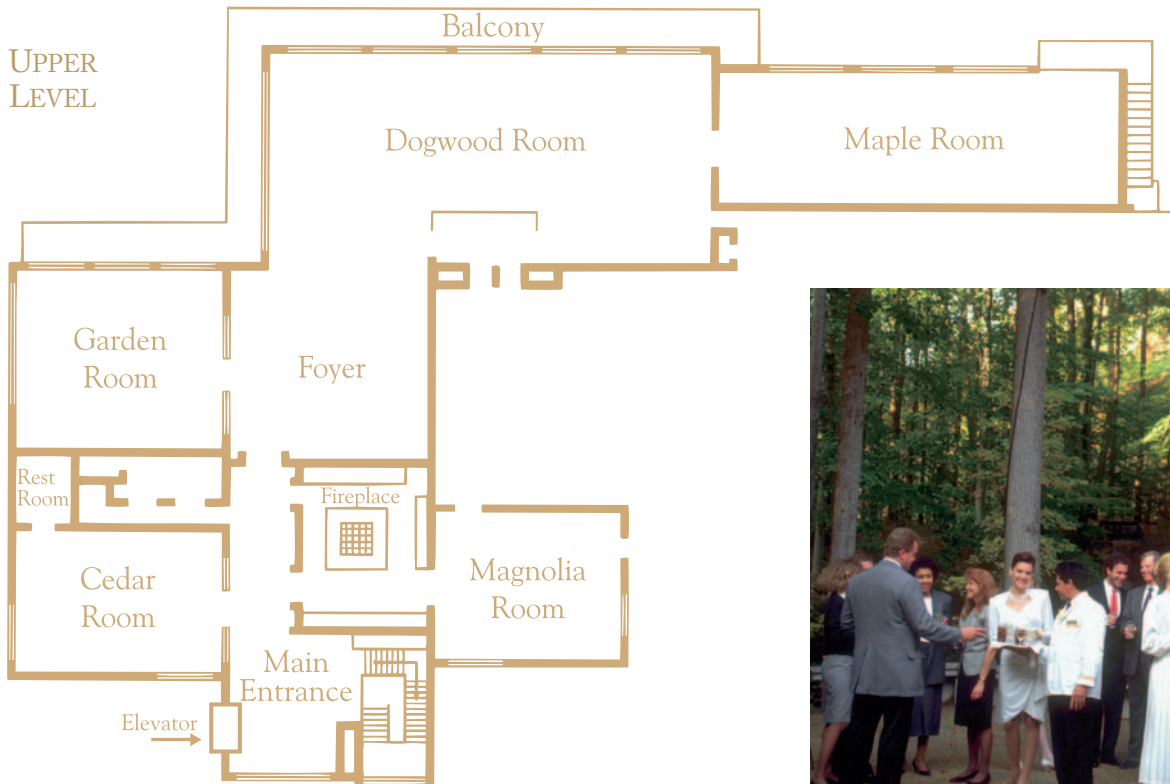

CASCADES TERRACE

	Banquet	Reception	Theater	Classroom	Conference	Hollow Sq.	U-Shape	Sq. Ft.	Dimensions	Ceiling Ht.
<i>Magnolia Room</i>	50	60	35	30	20	20	18	696	24' x 29'	10'
<i>Maple Room</i>	80	150	100	50	40	40	35	1,260	20' x 63'	12'
<i>Garden Room</i>	60	75	70	40	30	30	25	950	30' x 32'	10'
<i>Dogwood Room</i>	250	350	300	180	90	90	75	2,700	65' x 27'	9'4"—27'10"
<i>Cedar Room</i>	50	60	40	40	20	20	18	918	34' x 27'	10'



CASCADES ROOM



CASCADES FOYER



CASCADES TERRACE

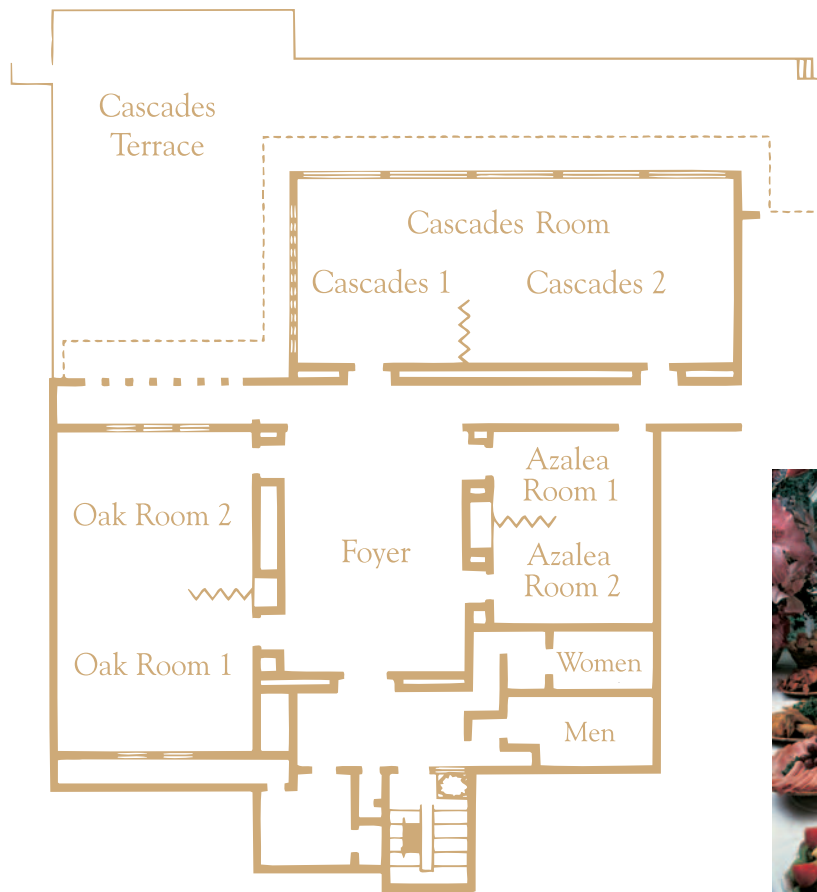

LOWER LEVEL



	Banquet	Reception	Theater	Classroom	Conference	Hollow Sq.	U-Shape	Sq. Ft.	Dimensions	Ceiling Ht.
<i>Oak</i>	140	200	200	105	45	45	40	1,800	53' x 34'	12'
<i>Oak (1 or 2)</i>	50	70	75	40	30	30	25	884	26' x 34'	12'
<i>Cascades</i>	180	250	250	150	70	70	65	2,232	72' x 31'	12'
<i>Cascades 1</i>	50	75	70	40	30	30	25	868	28' x 31'	12'
<i>Cascades 2</i>	100	150	120	60	40	40	35	1,333	42' x 31'	12'
<i>Azalea</i>	50	75	60	40	30	30	25	837	27' x 30'	10'
<i>Azalea (1 or 2)</i>	20	35	30	20	20	20	15	405	15' x 27'	10'
<i>Foyer</i>	–	200	–	–	–	–	–	1,450	31' x 47'	
<i>Cascades Terrace</i>	150	300	–	–	–	–	–	4,340	–	

DINING

- Daily continental breakfast included
- Huzzah!, a casual restaurant with outdoor seating and bar, located adjacent to the hotel
- 10 nearby restaurants including four historic dining taverns



RECREATION & ATTRACTIONS

- More than 40 shops close by in Merchants Square
- Complimentary shuffleboard, horseshoes, badminton, volleyball, table tennis, plus miniature golf at a nominal fee available on site
- New outdoor pool and deck
- Golf nearby at the award-winning Robert Trent Jones Sr.- and Rees Jones-designed Golden Horseshoe golf courses, 45 holes of golf including golf instruction and driving ranges
- Meeting conferees have access to our fitness center and massage services



LOCATION

- Directly adjacent to Colonial Williamsburg's Visitor Center
- Convenient complimentary shuttle bus or footpath leading to Colonial Williamsburg's world-renowned Historic Area
- Easily accessible off Route 60 or 132Y; minutes from I-64
- Within a 40-minute drive of Richmond or Norfolk airports; 20 minutes from Newport News-Williamsburg airport; minutes from Williamsburg's executive airstrip

Colonial Williamsburg Hotels

WILLIAMSBURG, VIRGINIA

*Williamsburg Inn, Colonial Houses—Historic Lodging, Williamsburg Lodge,
Woodlands Hotel & Suites, Governor's Inn*

Telephone: (757) 220-7600; Toll-free: 1-800-822-9127

